

FERMENTER, POSTFERMENTER

ECHELLE 1/100

CONDENSATIONSHAFT

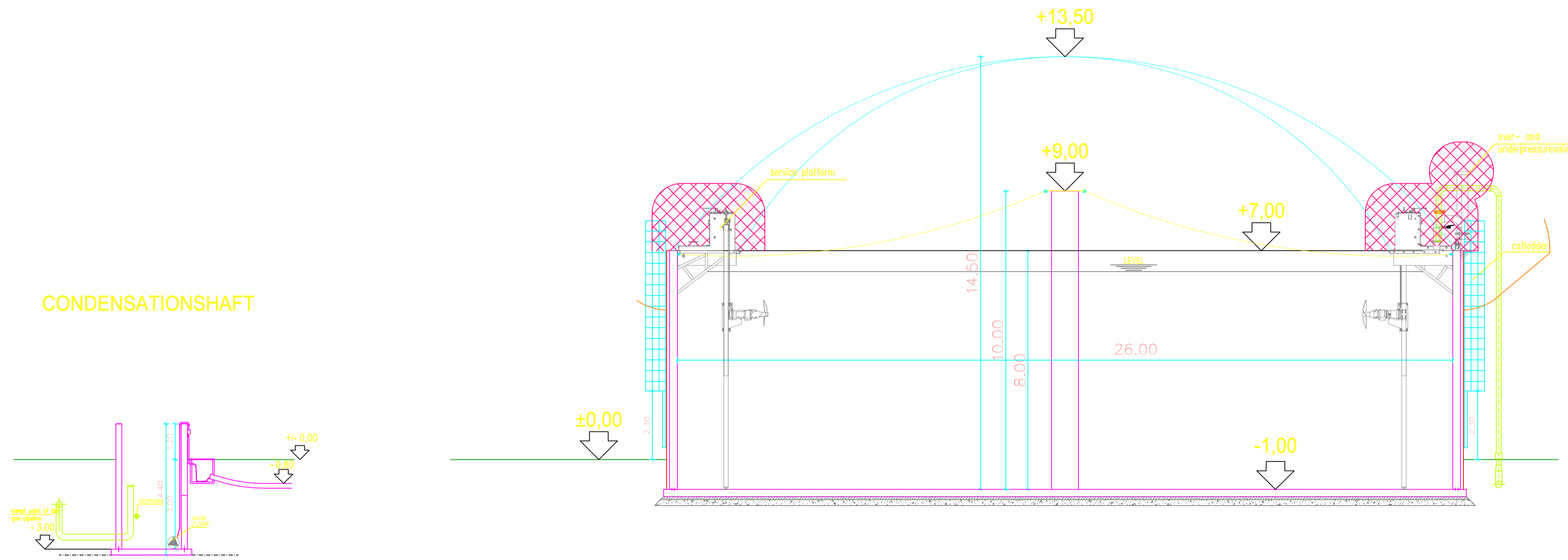

LEGEND

- Biogaspipes (PE / INOX) DN150
- Gasvalve
- ATEX Zone 1
- ATEX Zone 2

DESCRIPTION

**Zone 1:**  
A Zone 1 area is classified as a place in which an explosive atmosphere consisting of a mixture with air or flammable substances in the form of gas, vapour or mist is likely to occur in normal operation occasionally.

**Zone 2:**  
A Zone 2 area is classified as an atmosphere where a mixture of air and flammable substances in the form of gas, vapour or mist is not likely to occur in normal operation, but if it does occur, will persist for a short period only.

Clôture

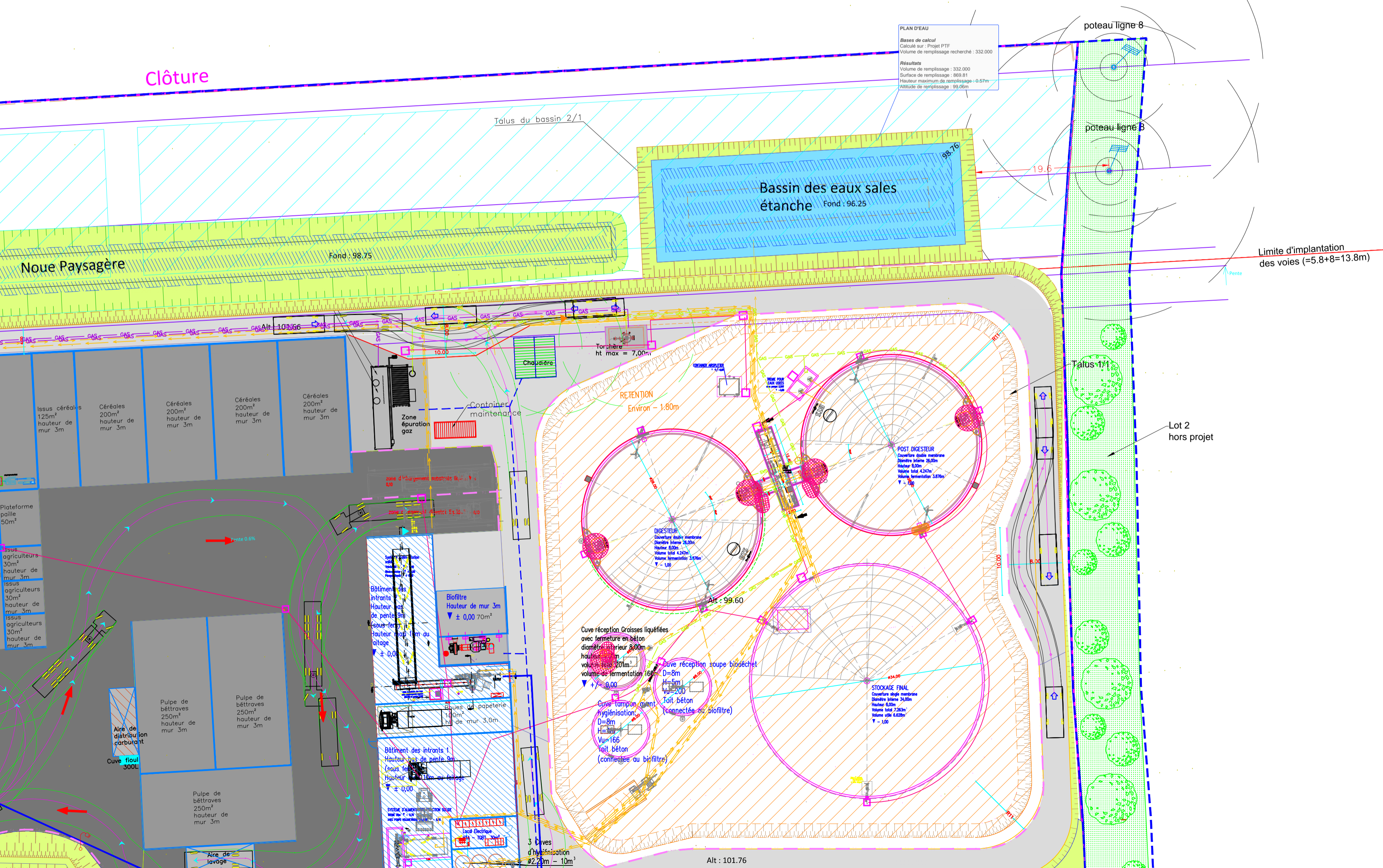

GIRUS GE  
Elcimai Ingenierie:  
3 rue de la Brasserie Gruber  
77000 Melun  
Tél: 01.64.10.47.20 - Fax: 01.64.87.84.11

Indice	date	modifications	diffusion	verification
A	18/05/2018	MISE A JOUR DU PLAN MASSE SELON OBS ICPE	HAL	EBL
0	26/09/2017	PREMIERE DIFFUSION	MTO	EBL

Zone ATEX 1

PROJET EQUIMETH -77-  
UNITE DE METHANISATION AGRICOLE  
Moret-Loing et Orvanne (77)

CPI

**elcimai** REALISATIONS  
3 rue de la Brasserie Gruber - 77000 Melun  
Tél: 01.64.10.47.20 - Fax: 01.64.87.84.11  
Email: eemelum@elcimai.com

**capvert energie bio**  
producteur engagé d'énergie durable  
4 Place Sadi-Carnot  
13002 Marseille  
04 86 76 03 60

N° Fichier : A31913 - Plan d'implantation avec g  
N° Plan : 001 indice :  
Ech. : 1/400  
N° Dossier : A31913 Format : A1 Resp. : MTO

Ce document est la propriété d'elcimai et ne peut être reproduit sans son autorisation.